



Mission

Our mission is to educate, strengthen and advocate for the community through services and partnerships, achieving optimal health and quality of life for all living in the Antelope Valley.

Vision

It is our vision that all children, families, and individuals in the Antelope Valley will have optimal psychosocial, physical and environmental health.

Core Values

At AVPH, everything we do is guided by a set of fundamental principles that define who we are and how we operate. Our core values are the base of our culture and drive our commitment to the Antelope Valley community.

**Integrity
Support
Connection
Dedication
Family
Trust
Collaboration**

Healthy People in a Healthy Antelope Valley

ANTELOPE VALLEY PARTNERS FOR HEALTH

Building a Healthier Future for the Antelope Valley

Capital Campaign



Antelope Valley Partners for Health

Community Collaborative Promoting Health and Wellness



(661)-942-4719



avphwebsite@avph.org



www.avph.org

AVPH BOARD OF DIRECTORS & DIRECTORS



Elvie Ancheta
Chair
Retired



Jill Zimmerman
Chair Elect/Former Chair
Antelope Valley College



Jannie Dutton
Vice Chair
Retired



Kevin Von Tungeln
Treasurer
*Thompson | Von Tungeln
Trust & Estate Lawyers*



Angela Underwood
Secretary
California Bank & Trust



Steven Angebrandt
Member
*Edward Jones
Financial Advisor*



Shandelyn Williams
Member
*Antelope Valley Union
High School District*



Rocio Castellanos
Member
L.A. Care



Benjamin Gocke
Member
*Palmdale Regional
Medical Center*



Henry W. Hearn
Member
Retired



Michelle Fluke
Executive Director of AVPH



Victoria Bibby
Director of Direct Services



Tiara Sigaran
Director of Community Impact



Our Region

Antelope Valley is a high desert located in northern Los Angeles County with parts permeating Southern Kern County. The region includes the cities of Lancaster, Palmdale, Rosamond, and Mojave, as well as a number of unincorporated areas. The map is focused on the part of the region within Los Angeles County with a total population of 402,000 residents.

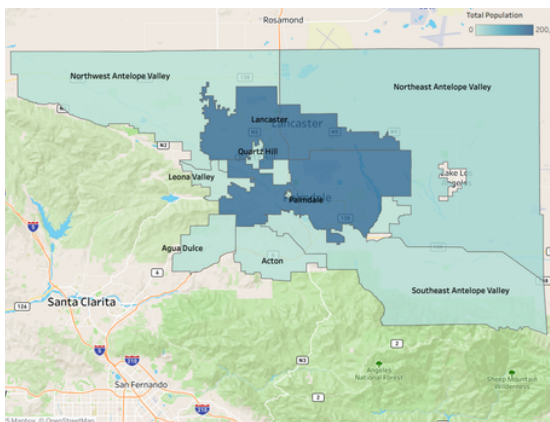

Our Disparities

The health statistics and rates for the Antelope Valley region are highly concerning and often higher compared to the LA County as a whole. To note a few, according to the 2025 Community Health Profiles Report developed by the Los Angeles County Department of Public Health, over 36.7% of adults in the area are obese, with over 15.1% of adults diagnosed with diabetes. The Antelope Valley area or Service Planning Area (SPA) 1 has the highest rates of obesity across all of Los Angeles County. Food insecurity is a high concern for our community, with 38.6% of adults in SPA 1 households facing this concern. Some major health indicators within the Antelope Valley area can include the lowest region in the county to have access to a livable community (walkable, available parks or playgrounds, or sports fields), lowest region with children having access to dental care, and lowest region with women receiving prenatal care during the first trimester of pregnancy. The Antelope Valley has high rates of mental illness, substance abuse and domestic violence with a lack of available resources to assist and provide services to these community members.

Our History

Antelope Valley Partners for Health serves as the local public health planning and intervention agency for over 25 years, and its programs target those who are underserved, vulnerable, frail, underinsured, or at risk of family breakdown or loss of independence. With a core focus on prevention and early intervention, AVPH is the largest grass-roots non-profit agency in the Antelope Valley, leading coalitions, developing collaborative partnerships, and providing training and capacity-building services to community-based organizations throughout the region as a vital agent of change.



Dr. Jill Zimmerman, Board of Director

“AVPH has a long history of serving this community with over 25 years of service meeting the needs of the most vulnerable population of the Antelope Valley. We are here and ready to serve, and this new building will expand our future to serving children, youth, adults and families so that everyone has a healthy and brighter future. Please become a part of the AVPH family and allowing your generous donation dollars to help us help our community.”

¹ USC Lusk Neighborhood Data for Social Change. Healthy people in a healthy Antelope Valley [Internet]. NDSC; [cited 2025 Apr 28]. Available from: <https://la.myneighborhooddata.org/2024/05/antelope-valley-partners-for-health/>

² Los Angeles County Department of Public Health. Community health profiles Valley [Internet]. LACDPH; [cited 2025 May 21]. Available from: https://apps.gis.lacounty.gov/static/DPH/community-profiles/?Geo_ID=spa_1



Home Visitation Program

Maternal & Child Health

Emotional Wellness

Health Education

Youth

Housing

Family Support

Workforce Development

Family Resource Center



Hot Meal Resources

Food Pantry Resources

Community Resources

Conference Center

Career Opportunities

Volunteer Opportunities

Violence Prevention Resources



Individuals Served in FY 2023 - 2024

109,454*

*duplicated - Some clients received services from multiple AVPH programs.

Maternal Child Health

6,568
individuals

Workforce Development

186
individuals

Family Resource Center

1,466
individuals

Food Pantry

13,690
individuals

Youth Services

9,058
individuals

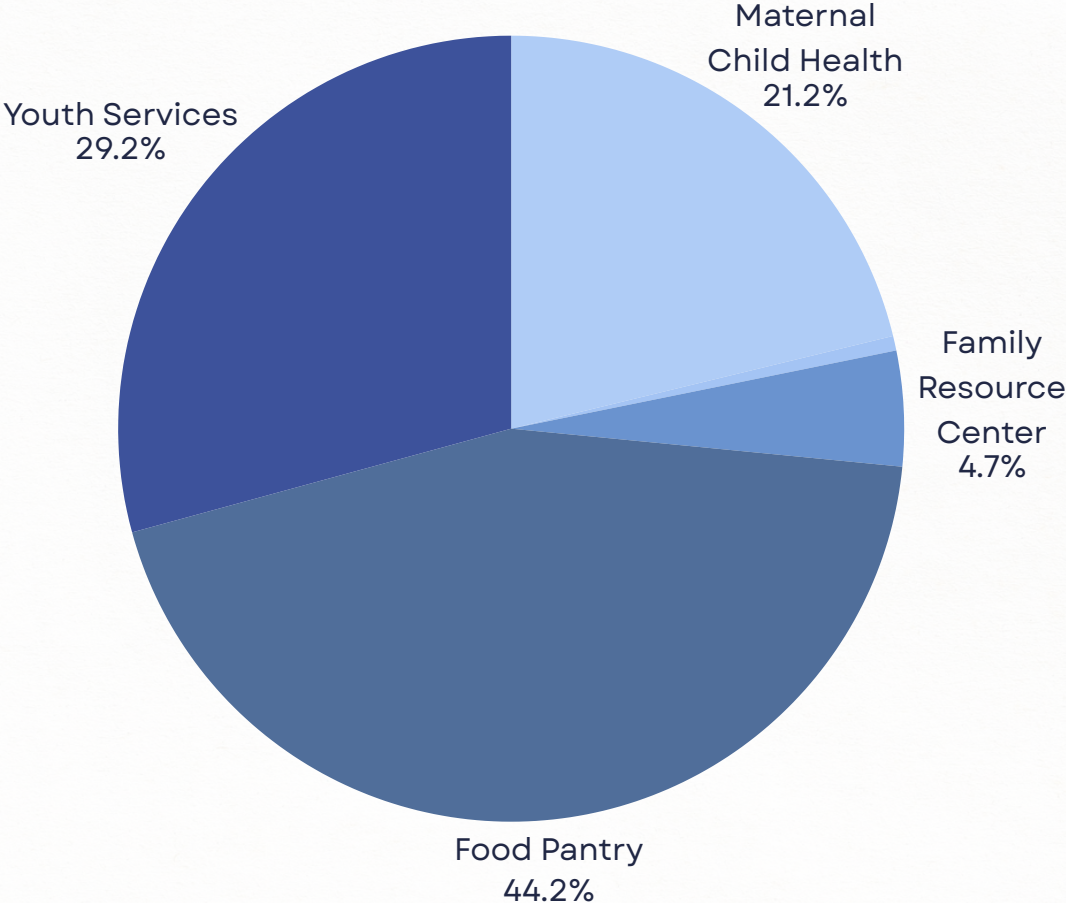



Antelope Valley Partners for Health is excited to announce the launch of our capital campaign,

“Building a Healthier Future for the Antelope Valley”

The campaign is aimed at raising **\$6 million** towards the **total \$8 million project cost** to move into a forever home in the Antelope Valley community. This transformative initiative will enable us to renovate a building in the community equipped with a new **Community Resource Center** and a **Youth Center** focused on community healing, health, and wellness; and enhance programs for pregnant mothers, children, youth, families in need, homeless individuals, and seniors in our community - all fostering trauma-informed care and collective impact. AVPH is committed to the community and excited to develop a beautiful state of the art facility that will welcome the community with warmth, empathy, and support in a safe and welcoming space for individuals of all ages to learn, grow, and connect. **AVPH is a homegrown organization providing services to the community for 25+ years and serving over 100,000 residents each year.**

Michelle Fluke, Executive Director

“This new building is more than just bricks and mortar; it represents our unwavering commitment to the Antelope Valley. We envision a space where every community member feels welcomed, supported, and empowered to achieve their optimal health and well-being. We are excited for the future of AVPH and the positive impact this new facility will have on the lives of those we serve.”

AVPH purchased a 34,000 square foot building in Lancaster, CA, conveniently located off 10th Street W, making it centrally located and easily accessible to the vulnerable communities we serve. This exciting acquisition marks the beginning of a full transformation to better meet the needs of both our dedicated staff and the community we support.

Our renovation will unfold in three key phases. **Phase one** will focus on bringing our entire team back under one roof after navigating the challenges of a hybrid schedule. This reunification will immediately enhance our ability to run our vital programming at its maximum capacity.

Phase two, we will build a dedicated event center. This space will not only offer a valuable venue for our community to host special events, but will also generate crucial revenue to support our programs and ensure long-term sustainability.

Phase three will see the development of a state-of-the-art Youth Center. This dedicated space will provide our younger population with access to a wide range of activities, workshops, and support services designed to foster their schoolwork, creativity, personal growth, and overall well-being. We are incredibly excited about the potential this new building holds for AVPH and the Lancaster community!



Reclaiming Visibility, Rebuilding Access: A Home That Restores Our Impact

For years, our organization thrived in a building where visibility and accessibility were our greatest allies. On any given day, individuals from across the Antelope Valley would walk through our doors—seeking support, information, comfort, or simply a place where they felt seen. Those walk-ins were more than foot traffic; they were moments of connection, opportunities for prevention, and the foundation of trust with the community we serve.

But today, we are operating from a temporary site—hidden from public view, limited in space, and unable to fully house our team. Many staff members are forced to work remotely, not by choice but by necessity. This distance, both physical and symbolic, has reduced spontaneous community engagement and has constrained our ability to provide the immediate, accessible support that has always defined our work. The Antelope Valley still needs us. But from this temporary location, too many people cannot find us when they need us most.



Our new permanent building, located prominently at J-4 and 10th Street West, will change that.

Located in a highly visible and central area, the new site will allow us to restore what has been missing: walk-in access, community presence, and the simple but powerful ability for someone passing by to realize help is right here if I ever need it. **We do not serve only those who are in crisis today—we also serve those who may need us tomorrow.** A visible, welcoming, and permanent home is essential to ensuring that individuals and families know where to turn long before a crisis becomes overwhelming.

This new building strengthens more than our connection to the community—it strengthens our organization from within. Reuniting our staff under one roof will enhance collaboration, communication, and the quality of services we provide. No more scattered offices, no more remote work out of necessity, no more barriers between our team and the people we serve. Just one unified space dedicated to empowerment, prevention, and healing.

Supporting this capital campaign is not simply contributing to a building. It is investing in restored accessibility, renewed community trust, and expanded capacity to meet the growing needs of the Antelope Valley. It is helping us return to the visibility that once allowed us to reach thousands—and ensuring that anyone, at any moment, can walk through our doors and find support, safety, and hope.

Together, we can open those doors again.

Building Our Forever Home

MARCH 2025
GROUND BREAKING

JULY 2025
PHASE 1
Employee Area

MARCH 2026
PHASE 2
Event Center

JULY 2026
PHASE 3
Youth Center

JULY 2026
GRAND OPENING
Official Welcome

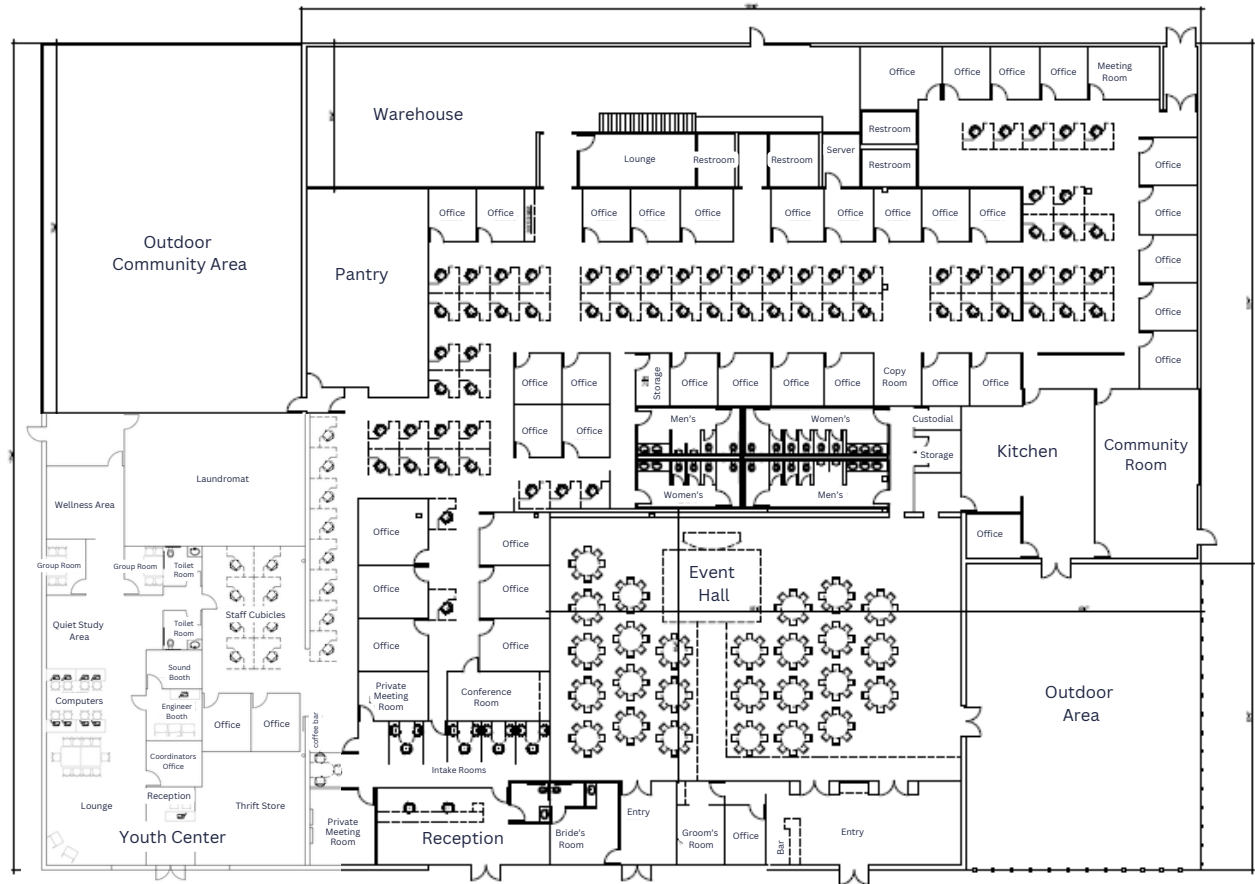

Employee Area

- Reception
- Cubicles
- Offices for leadership
- Storage space
- Food pantry distribution area
- Warehouse
- Breakroom
- Kitchen

Youth Center

- Youth lounge area
- Laundry mat
- Thrift store
- Podcast room
- Juice bar
- Extra curricular room

Event Center

- Event hall
- Bride room / Groom room
- Bar
- Community Room

Pillars of Impact: Investment Opportunities That Align With Your Mission

Our work in the Antelope Valley is built on a foundation of comprehensive, people-centered services. Each program area plays a vital role in prevention, intervention, stability, healing, and long-term wellbeing. As we launch our capital campaign for the new facility at J-4 and 10th Street West, we invite mission-aligned partners to invest in the pillars that best reflect their values, goals, and areas of focus.

Each pillar reflects a critical part of our work and a distinct opportunity for meaningful partnership. Whether your focus is immediate community support, youth empowerment, mental health, community outreach, or organizational strength, there is a place for your mission to live within ours.

By supporting a pillar that aligns with your values, you could help build a future where individuals and families across the Antelope Valley can access support, safety, and opportunity within a visible, welcoming, and unified home.

Pillar 1:
**Community
Immediate Support**

Pillar 2:
**Prevention, Education
& Community Outreach**

Pillar 3:
**Youth & Family
Empowerment**

Pillar 4:
**Long-Term Support,
Case Management &
Home Visitation**

Pillar 5:
**Organizational
Capacity & Workforce
Strength**

Pillar 6:
**Community Access
& Visibility**

A Place for Every Mission, A Pillar for Every Partner

Pillar 1: Community Immediate Support

For funders dedicated to providing tangible help and resources.

This pillar supports the frontline services that help individuals and families access immediate support—walk-in assistance, guidance, referrals, and essential resources when they need it most.

Your funding could support:

- Immediate walk-in services
- Emergency basic needs support
- Crisis navigation & safety planning
- Rapid connection to community resources

Pillar 2: Prevention, Education & Community Outreach

For funders committed to long-term community health, awareness, and prevention.

Investing in this pillar strengthens our capacity to reach the community, build awareness, and equip individuals with knowledge that empowers them before crisis ever arises.

Your funding could support:

- Community workshops
- Outreach events in the Antelope Valley
- Prevention campaigns
- Public awareness materials and engagement

Pillar 3: Youth & Family Empowerment

For funders focused on youth well-being & development and family strengthening.

Our youth and family programs ensure that young people and parents have access to education, counseling resources, and safe spaces that nurture healthy development and positive futures.

Your funding could support:

- Youth leadership and empowerment programs
- Family support services
- Parent education and skill-building
- Safe spaces for youth engagement

Pillar 4: Long-Term Support, Case Management & Home Visitation

For funders supporting sustained guidance, family stability, and long-term wellbeing.

By investing in this pillar, you support ongoing case management and home visitation services that help individuals and families navigate challenges, build stability, and strengthen their capacity to thrive.

Your funding could support:

- Individualized case management plans
- Home visitation services for families & individuals
- Long-term goal setting, monitoring & support
- Navigation of community resources, benefits, & systems

Pillar 5: Organizational Capacity & Workforce Strength

For funders focused on sustainability, staff development, and operational excellence.

Our staff are the heart of our mission. This pillar supports the people, processes, and tools that make high-quality service possible—ensuring strong organizational health and long-term impact.

Your funding could support:

- Staff training & professional development
- Technology and operational systems
- Unified workspace for improved collaboration
- Enhanced capacity to meet increasing community needs

Pillar 6: Community Access & Visibility

For funders committed to community engagement, accessibility, and equity.

This pillar supports the creation of a visible, accessible space at J-4 and 10th Street West—a place where individuals know they can walk in, be welcomed, and find support.

Your funding could support:

- Walk-in access areas
- Community resource hub spaces
- Reception and intake areas
- Signage and visibility enhancements

Supporting Our Campaign

Naming Opportunities

The campaign offers a variety of meaningful and lasting naming opportunities. Rather than choosing personal recognition, donors can honor someone special, celebrate an organization they care about, or commemorate a loved one by naming a room or space in their honor. It's a heartfelt way to create a legacy while supporting a place that will uplift the community for years to come.

Donations of at least \$2,000 will be prominently displayed in the Reception Area.

1. Front Facade beautification.....	\$500,000	(1)
a. Front benches.....	\$3,000	(4)
2. Event Center.....	\$500,000	(1)
a. Outdoor Area.....	\$10,000	(1)
b. Bride Room.....	\$10,000	(1)
c. Groom Room.....	\$5,000	(1)
3. Youth Center.....	\$350,000	(1)
a. Lounge Center.....	\$15,000	(1)
b. Laundry Mat.....	\$15,000	(1)
c. Podcast Room.....	\$10,000	(1)
d. Thrift Store.....	\$10,000	(1)
e. Snack Bar.....	\$5,000	(1)
4. Kitchen.....	\$200,000	(1)
5. Outdoor Community Area.....	\$100,000	(1)
a. Outdoor benches.....	\$1,500	(6)
6. Community Room.....	\$25,000	(1)
7. Food Pantry.....	\$15,000	(1)
8. Admin Suite.....	\$10,000	(1)
9. Reception.....	\$5,000	(1)
10. Warehouse.....	\$5,000	(1)
11. Intake Rooms.....	\$2,500	(5)
12. Staff Lounge.....	\$2,000	(1)
13. Staff Cafe.....	\$2,000	(1)
14. Emotional Wellness.....	\$2,000	(1)
15. Lactation Center.....	\$2,000	(1)
16. Kids Corner.....	\$2,000	(1)
17. Server/IT Room.....	\$2,000	(1)

How to Make a Gift

Monetary Contribution

Monetary contributions may be collected in the form of a check, charging your MasterCard or Visa, or wiring or transferring funds electronically.

Pledges

A pledge allows you to make a gift over as many as five years. AVPH will send you pledge reminders according to the schedule your request. You may make a pledge online at www.avph.org.

Matching Gifts

Some companies match charitable gifts given by their employees. Forward your company's matching gift form with your gift. If your organization doesn't have a formal program, ask them to consider matching your gift.



Your gift leaves a lasting legacy, building a healthier Antelope Valley for generations to come.

Join Us

in Building a Healthier Future for the Youth of the AV

Your generous support will directly impact the lives of hundreds of thousands of community members, ensuring they receive the support, education, and guidance in a compassionate manner. Join us in this vital mission to advance health and wellness in our community—together, we can build a healthier future for all Antelope Valley residents.



Michelle Fluke
EXECUTIVE DIRECTOR



 661-645-8422

 mfluke@avph.org

 4083 W Avenue L #370
Lancaster, CA 93536



Isabel Santiago
EXECUTIVE COORDINATOR



 661-499-7711

 isantiago@avph.org

 4083 W Avenue L #370
Lancaster, CA 93536